



**Byjia Sheepcote Road, Eton Wick, Berkshire, SL4 6JA**  
**£475,000**

 **HORLER**

## Byjia Sheepcote Road, Eton Wick, Berkshire, SL4 6JA

Located in the charming village of Eton Wick, this delightful two-bedroom semi-detached bungalow on Sheepcote Road offers a perfect blend of comfort and convenience. The property is ideally situated close to local schools, amenities, and excellent transport links, making it an attractive option for families and commuters alike.

Outside, the property benefits from a detached garage adjacent to the house, complete with a large workshop at the rear, offering additional storage solutions. The driveway provides off-road parking for several vehicles, a valuable asset in this desirable area.

Why not call today on 01753 621234



## PROPERTY SUMMARY

Located in the charming village of Eton Wick, this delightful two-bedroom semi-detached bungalow on Sheepcote Road offers a perfect blend of comfort and convenience. The property is ideally situated close to local schools, amenities, and excellent transport links, making it an attractive option for families and commuters alike.

The property comprises a spacious living and dining room, which is bathed in natural light thanks to the French doors that open directly onto the back garden. This inviting space is perfect for both relaxation and entertaining guests. The fitted kitchen boasts a range of eye and base level units, providing ample storage and functionality, and it seamlessly connects to a lovely conservatory, ideal for enjoying the garden views throughout the seasons.

The bungalow features two generously sized double bedrooms, ensuring plenty of space for rest and relaxation. A well-appointed family bathroom and a separate WC add to the practicality of the layout, catering to the needs of modern living.

Outside, the property benefits from a single garage adjacent to the house, complete with a large store room at the rear, offering additional storage solutions. The driveway provides off-road parking for several vehicles, a valuable asset in this desirable area.

This charming bungalow presents an excellent opportunity for those seeking a comfortable home in a peaceful yet accessible location. With its spacious interiors and convenient amenities nearby, it is sure to appeal to a wide range of buyers.

## GENERAL INFORMATION

Council Tax Band 'D'

## LEGAL NOTE

\*\*\*Although these particulars are thought to be materially correct their accuracy cannot be guaranteed and they do not form part of any contract\*\*\*





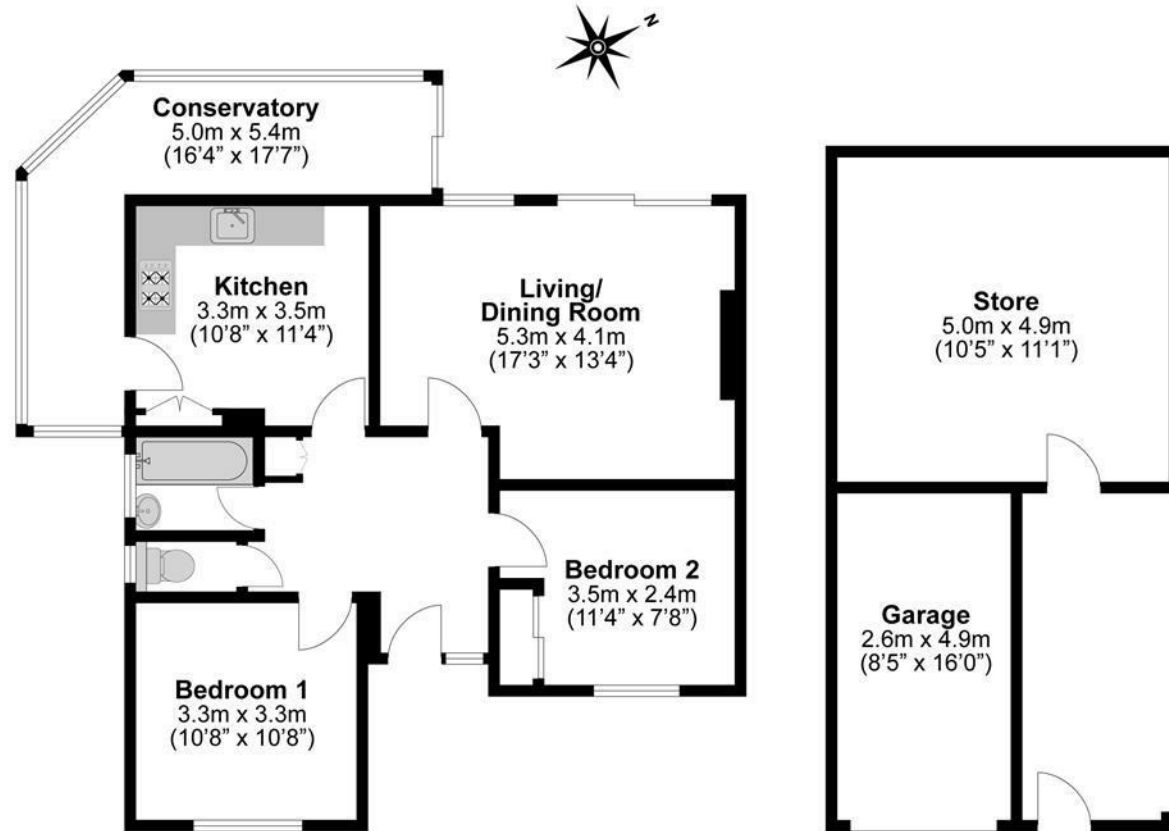

**Illustrations are for identification purposes only,  
measurements are approximate, not to scale.**